

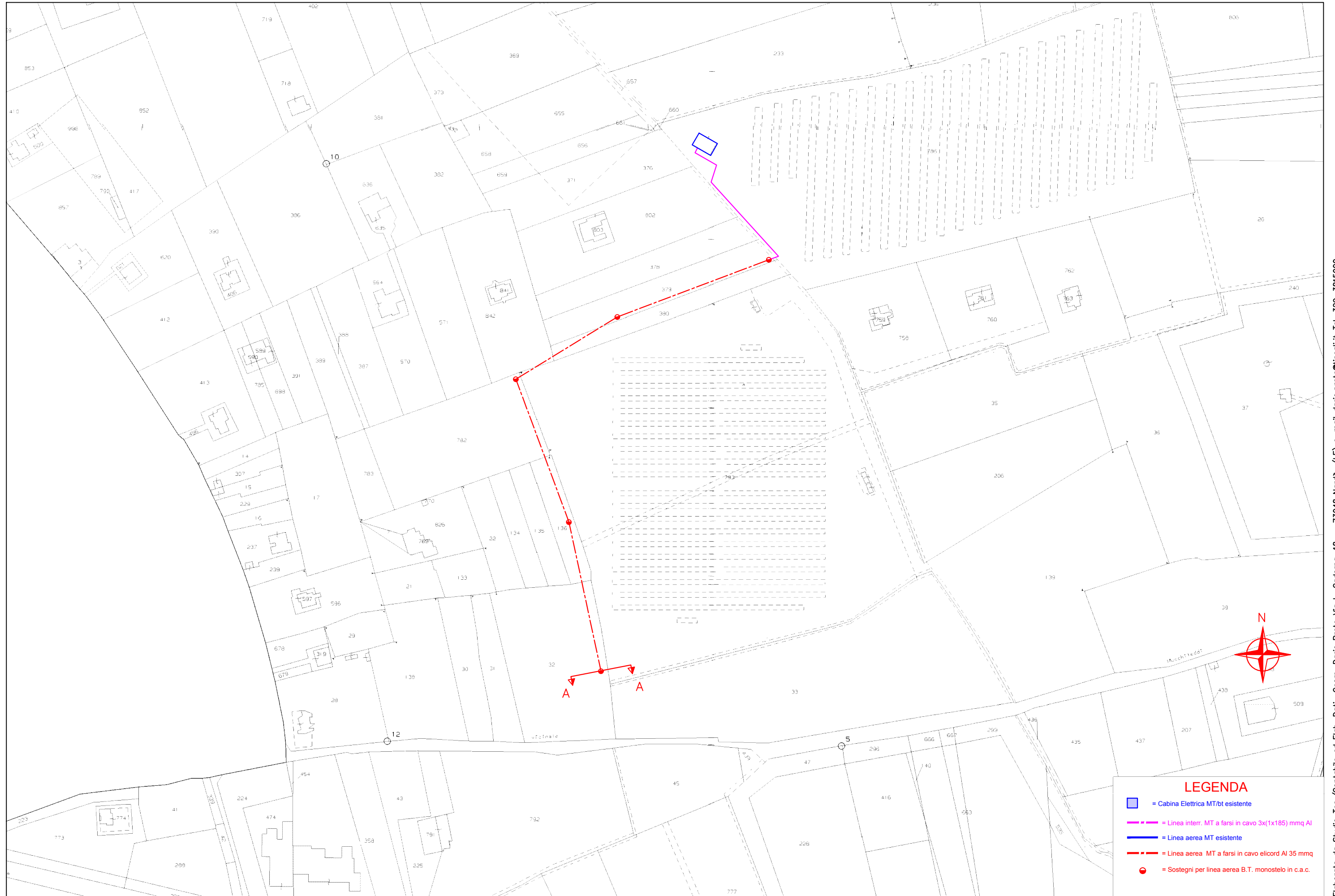





STRALCIO PLANIMETRICO

COMUNE di PARABITA Fg. 12

Scala 1:2000



LEGENDA

-  = Cabina Elettrica MT/bt esistente
-  = Linea interr. MT a fasci in cavo 3x(1x185) mmq Al
-  = Linea aerea MT esistente
-  = Linea aerea MT a fasci in cavo elicord Al 35 mmq
-  = Sostegni per linea aerea B.T. monostelo in c.a.c.



STRALCIO PLANIMETRICO

COMUNE di PARABITA Fg. 12

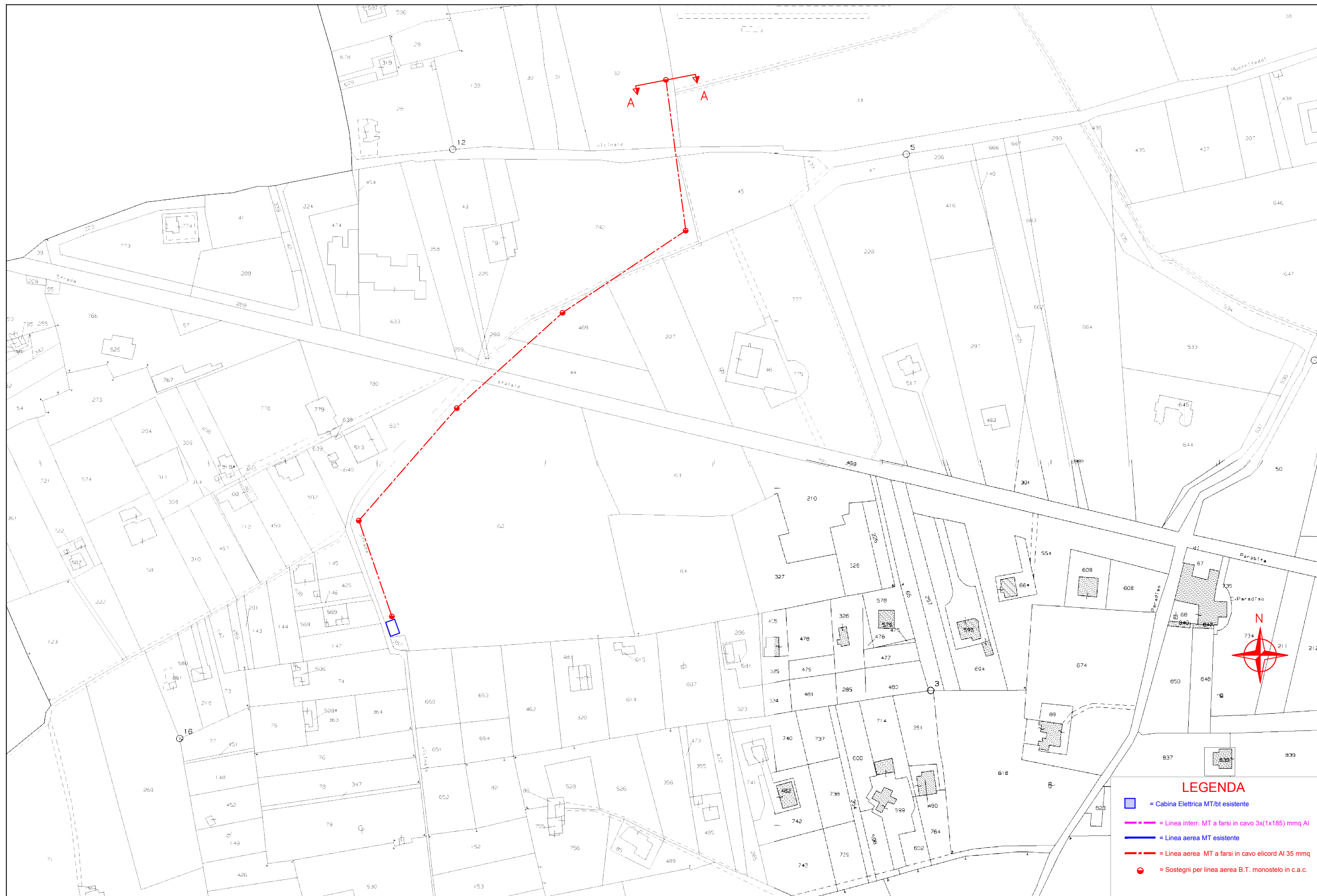
Scala 1:2000



LEGENDA

-  = Cabina Elettrica MT/HT esistente
-  = Linea interr. MT a fasci in cavo 3x(1x185) mmq AI
-  = Linea aerea MT esistente
-  = Linea aerea MT a fasci in cavo elicoid AI 35 mmq
-  = Sostegni per linea aerea B.T. monostelo in c.a.c.